

ZONE		REVISIONS				APVD	
LTR.	DESCRIPTION	DATE	ECN	BY	CKD	APVD	
-	C	REDRAWN FOR LABELING CONSISTENCY	01/02/16	2016-67	TB	AB	AA

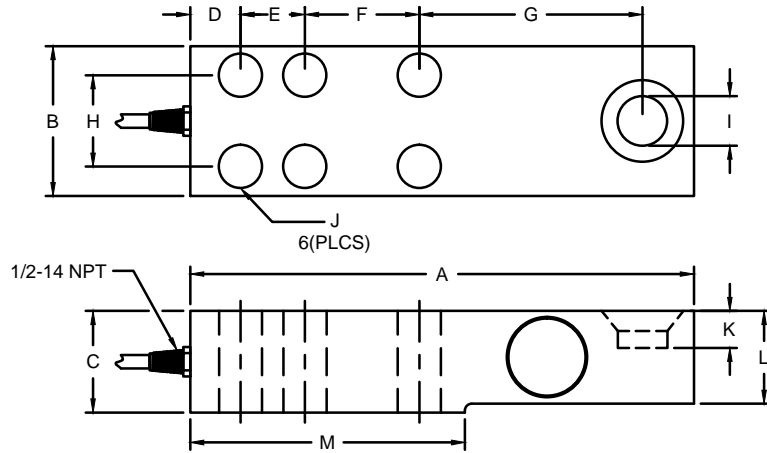

PERFORMANCE SPECIFICATIONS:

1. CAPACITIES: *115K. (LB) *BLIND LOAD HOLE
2. RATED OUTPUT: 2.30 mV/V $\pm 0.25\%$.
3. SAFE OVERLOAD: 150% FS.
4. EXCITATION VOLTAGE: 10V AC/DC (15V MAX).
5. INPUT RESISTANCE: 1000 $\pm 10\Omega$.
6. OUTPUT RESISTANCE: 1000 $\pm 5\Omega$.
7. ZERO BALANCE: $\pm 1.00\%$ FS.
8. SEAL TYPE: ENVIRONMENTALLY-SEAL IP67.
9. NON-LINEARITY: $\pm 0.03\%$ FS.
10. HYSTERESIS: $\pm 0.03\%$ FS.
11. REPEATABILITY: $\pm 0.01\%$ FS.
12. CREEP: $\pm 0.02\%$ FS IN 30 MINUTES.
13. COMPENSATED TEMPERATURE RANGE: -10°C TO $+40^{\circ}\text{C}$.
14. TEMPERATURE EFFECT ON ZERO: $\pm 0.0027\%$ FS/ $^{\circ}\text{C}$.
15. TEMPERATURE EFFECT ON OUTPUT: $\pm 0.0015\%$ FS/ $^{\circ}\text{C}$.
16. INSULATION RESISTANCE: 5000 MEGOHMS.
17. LOAD CELL CABLE: 4-22AWG, $\varnothing 6.8\text{MM}$, BRAIDED 50FT.
18. LOAD CELL WIRING:
 GRN (+EXC)
 BLK (-EXC)
 WHT (+SIG)
 RED (-SIG)
 BRAID/YELLOW: SHIELD
19. FM APPROVED.

RATED CAPACITY	DIMENSIONS												
	A	B	C	D	E	F	G	H	I	J	K	L	M
115K	16.38	3.75	5.62	1.01	2.12	3.62	7.75	2.12	2.00	1.06	1.25	4.00	8.25

DO NOT ALTER WITHOUT AGENCY NOTIFICATION

COTI GLOBAL SENSORS, INC.

CG - SB3-1
LOAD CELL

	APPROVALS		DATE	THIS DOCUMENT CONTAINS PROPRIETARY INFORMATION AND SUCH INFORMATION MAY NOT BE REPRODUCED OR DISCLOSED FOR ANY PURPOSE OR USED TO PRODUCE THE ARTICLE OR SUBJECT WITHOUT WRITTEN PERMISSION FROM COTI GLOBAL SENSORS, INC.	TOLERANCES UNLESS OTHERWISE SPECIFIED .XX = $\pm 0.02^{\circ}$.XXX = $\pm 0.005^{\circ}$.XXXX = $\pm 0.0002^{\circ}$ FRACTIONS: $\pm 1/16^{\circ}$ ANGLES DEC: ± 18		
	DRAWN:	RLU	06/16/15				
	CHECKED:	AA	06/16/15				
	ENGINEER:	JSP	06/16/15				
APPROVED:	AA	06/16/15					
MATERIAL:	ALLOY STEEL			SCALE	SIZE	PART/DRAWING NO.	REV.
FINISH:	NICKEL PLATED			NONE	B	DOD-CG-SB3-1	C
				MODEL	CG-SB3-1		SHEET 1 OF 1